

# COMPLET

## Modular skylight for HI-CT roofs



### Description and applications

#### Product

Modular cellular polycarbonate skylight, with high protection against UV rays, high durability, high thermal insulation and easy and simple assembly. Designed to be modulated with the HI-CT panel, with a useful width of 573 mm or 1,150 mm.

#### Applications

Natural lighting on HI-CT panel insulating roofs for industrial, residential and commercial buildings and sports facilities.

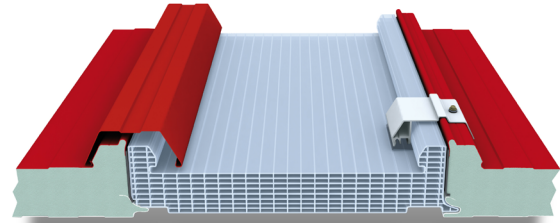

### Technical characteristics

The kit includes the COMPLET 7-wall polycarbonate skylights, the aluminium clips and the required lower joint profiles. In the case of a double-plaque installation, the aluminium clamps and polycarbonate cover plates are also provided.

<b>Thickness</b>	30 mm
<b>Module useful width</b>	573 mm
<b>Panel length</b>	No limit
<b>Range of service temperature</b>	-40°C to +120°C
<b>Acoustic insulation</b>	21 dB
<b>Thermal insulation</b>	1.28 W/m <sup>2</sup> K
<b>Reaction to fire</b>	Euroclase B-s1,d0
<b>Liear expansion coefficient</b>	0.065 mm/m°C (lineal)

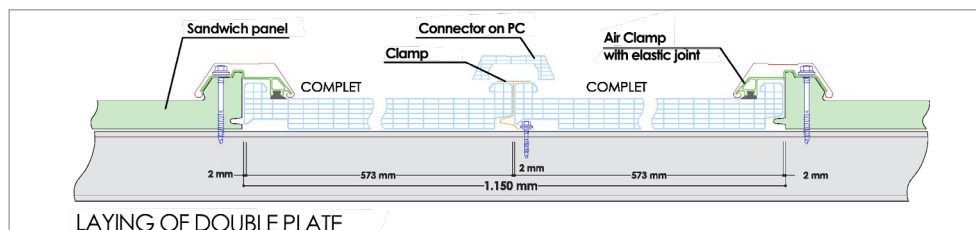
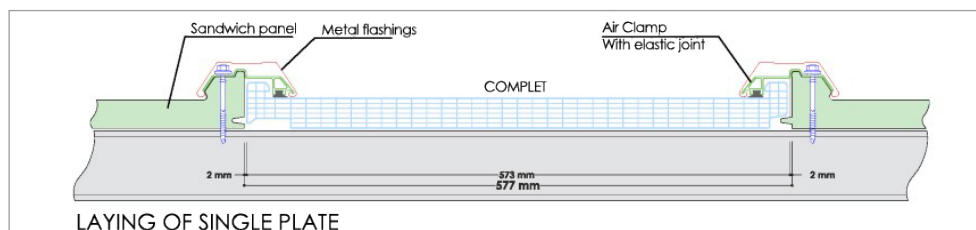

#### Huurre Ibérica S.A.U.

Carrer Serinyà 43, Polígono Industrial El Trust  
Cassà de la Selva (CP 17244)

ES-A17202375

Girona (Spain)

☎ (+34) 972 463 085

✉ huurre@huurreiberica.com



Huurre Ibérica S.A.U. reserves the right to modify the contents of this document without any prior warning. Every effort has been made to ensure that the content of this publication is accurate, but Huurre Ibérica S.A.U. and its affiliated companies are not responsible for errors or information that may be misleading. Suggestions regarding the final use or application of the products or work methods are merely informative and Huurre Ibérica S.A.U. and its affiliates do not accept any responsibility in this regard.